

Item	Description	HP Part No.	Qty
1	Flow Manifold Block, TCD and ECD	19232- 20500	1
2	O- Ring, 0.239- inch id	0905- 1014	1
	package of 12	5180- 4182	-
3	Restrictor, ECD Air, Green	19234- 60570	1
4	Inlet Fitting	19231- 20560	1
5	Rear Clamping Plate	19231- 40010	1
6	Screw, M4 x 12 mm	0515- 0909	3
7	Needle Valve Assembly	19231- 60650	1
	(4 of Item 8 installed on each)		
8	Non- Greased O- Ring, 0.208- inch id "Viton"	0905- 0999	4
	package of 12	5061- 5867	-
	package of 2, greased	5181- 1251	-
9	Front Clamping Plate	19231- 40070	1
10	Mounting Screw, M4 x 45- mm long	0515- 0964	1
11	Outlet Fitting Plate	19231- 00060	1
12	Front Ferrule, Brass, 1/8- inch tube	0100- 0032	1
13	Back Ferrule, Brass, 1/8- inch tube	0100- 0036	1
14	Hex Nut, Brass, 1/8- inch tube	0100- 0058	1
15	O- Ring, 0.114 - inch id	0905- 1039	3
	package of 12	5180- 4181	-
16	Weldment, ECD Makeup Gas	19233- 80550	1

**Figure 3. 19233A/19235A ECD Flow Manifold Block Assembly (Sheet 1 of 2).**

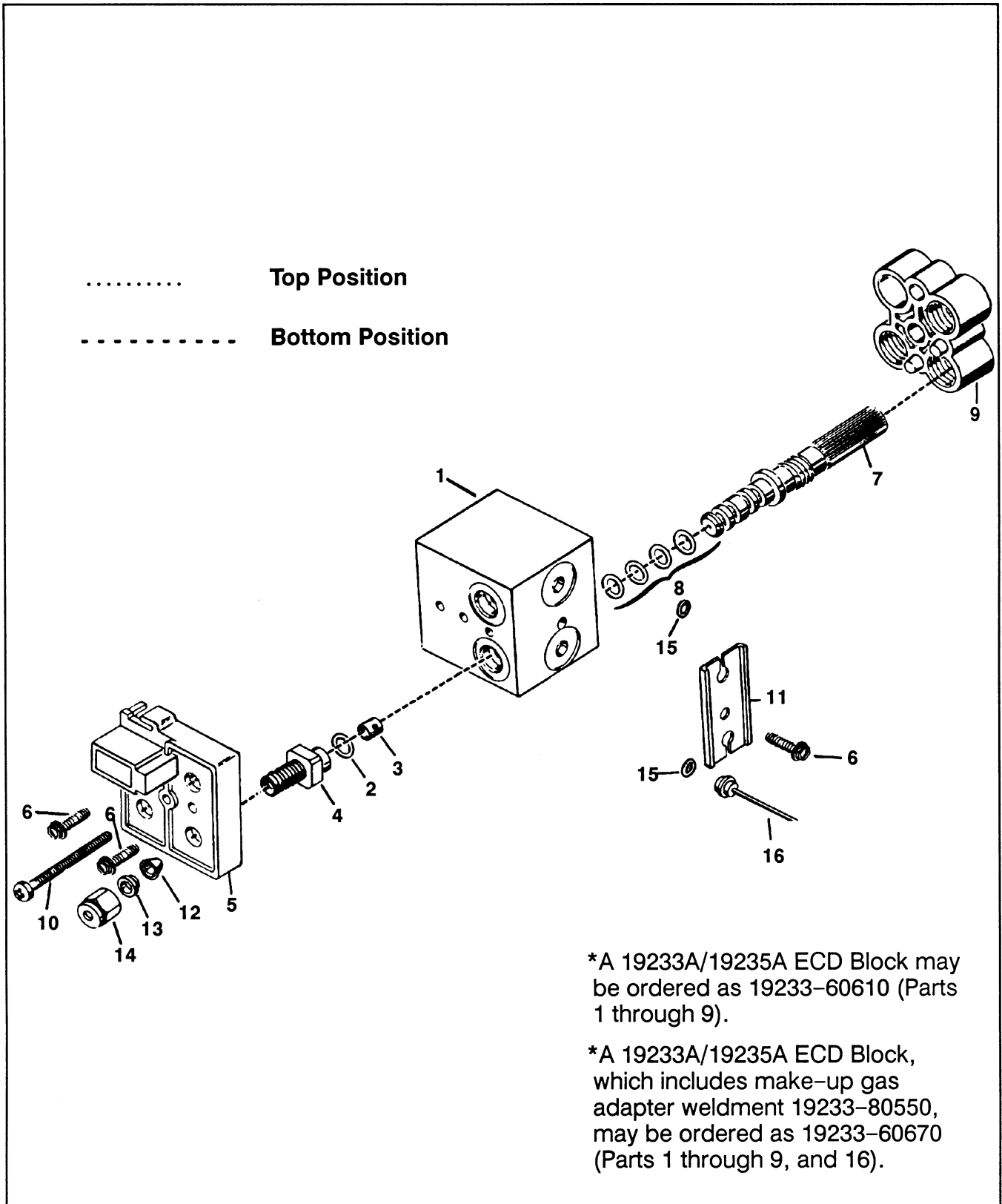

Figure 3. 19233A/19235A ECD Flow Manifold Block Assembly (Sheet 2 of 2).